





-  **Raffinatrice da pasticceria**
-  **Pastry grinding machine**
-  **Broyeuse pour pâtisserie**

mod. **RP2**

**RAFFINATRICE** da pasticceria con 2 cilindri in porfido da mm 300 e diametro mm 140.  
Struttura in lamiera di acciaio.  
Tramoggia in acciaio inox.  
Bacinella raccolta in acciaio inox.

**PASTRY GRINDING MACHINE** with two porphyry rollers 300 mm wide and diameter 140 mm.  
Stainless sheet structure.  
Stainless steel hopper.  
Stainless steel collecting drawer.

**BROYEUSE** pour pâtisserie avec deux rouleaux en porphyre de 300 mm et diamètre 140 mm.  
Structure en tôle d'acier.  
Trémie en acier inox.  
Cuve de ramassage en acier inox.

**Opzionale**

**Optional**

**Option**

Bacinella in acciaio inox.

Stainless steel bowl.

Cuve en acier inox.

**DATI TECNICI - TECHNICAL FEATURES - CARACTERISTIQUES TECHNIQUES**

MOD.	Potenza motore Motor power Puissance moteur kW	Dimensioni Size Dimensions (LxPxH) mm	Dimensioni imballo Packaging size Dimensions emballage (LxPxH) mm	Massa macchina Machine mass Masse machine kg	Massa con imballo Mass with packaging Masse avec emballage kg
RP 2	1.47	800 x 654 x 1166	890 x 640 x 1360	215	235

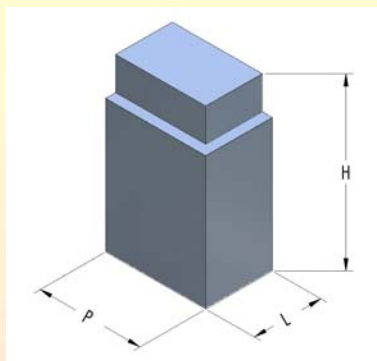

E' prassi della Ditta apportare continui miglioramenti ai prodotti, perciò i dati del presente catalogo sono puramente indicativi.

The Company's policy is one of continuous improvements and development; therefore specifications are subject to change without notice.

La Société poursuit une politique d'améliorations constantes et se réserve le droit de modifier en tout temps et sans préavis les caractéristiques de ses machines et équipements.



**Costruzioni Meccaniche SOTTORIVA S.p.A.**  
Via Vittorio Veneto, 63 - 36035 MARANO VICENTINO (Vicenza) Italy  
Tel./Phone (+39) 0445.595.111 - Fax (+39) 0445.595.155  
Internet: <http://www.sottoriva.com> - E-mail: [sottoriva@sottoriva.com](mailto:sottoriva@sottoriva.com)